

⚠ WARNING

Please read and understand these instructions completely before installation to avoid possible injury to yourself, or damage to the accessory or vehicle.

CAUTION:

- This installation should be performed by an authorized Yamaha dealer or a qualified mechanic. Some components require information from the model's service manual for proper installation or adjustment. Be sure to have the service manual on hand, if necessary, before proceeding with the installation.
- Alteration of emission-related components constitutes tampering under Federal and State laws and can lead to substantial fines and penalties if used other than in closed-course competition.
- Engine-related competition parts are intended for closed-course racing applications only.

DEALER:

These instructions contain important information for future reference and *must* be given to the customer.

WARRANTY INFORMATION:

- Genuine Yamaha accessories are covered by a 90-day warranty against defects in material or workmanship. Labor for replacement of defective components is not covered. See your Yamaha dealer for a copy of the warranty statement.
- The Limited Warranty provided with new Yamaha vehicles has exclusions for certain failures, including those caused by competition or racing use (except YZ and WR motorcycle models) as well as by abnormal strain or abuse. While installation of these components will not "void" your vehicle's warranty, specific failures adjudged by Yamaha to have resulted from the installation of accessory components or other modifications, or from competition use (except YZ and WR motorcycle models), may not be covered by warranty or Yamaha Extended Service.

PARTS LIST:

This kit contains the following components. Before beginning installation confirm there are no missing or damaged components.

Item #	Part Number	Description	Qty
--	1XD-F83M0-V0	Wind Defector Kit	1
1	*	Wind Deflector	1
2	*	Clamp	2
3	*	Button Head Bolt	4
4	*	Washer	4
5	*	Hood Stay	2
6	*	Hood Protector	2
7	*	Rivet	2

* Part supplied with kit only and not available separately.

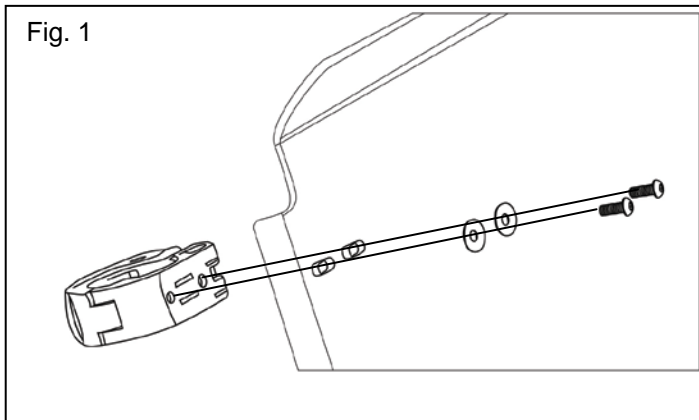
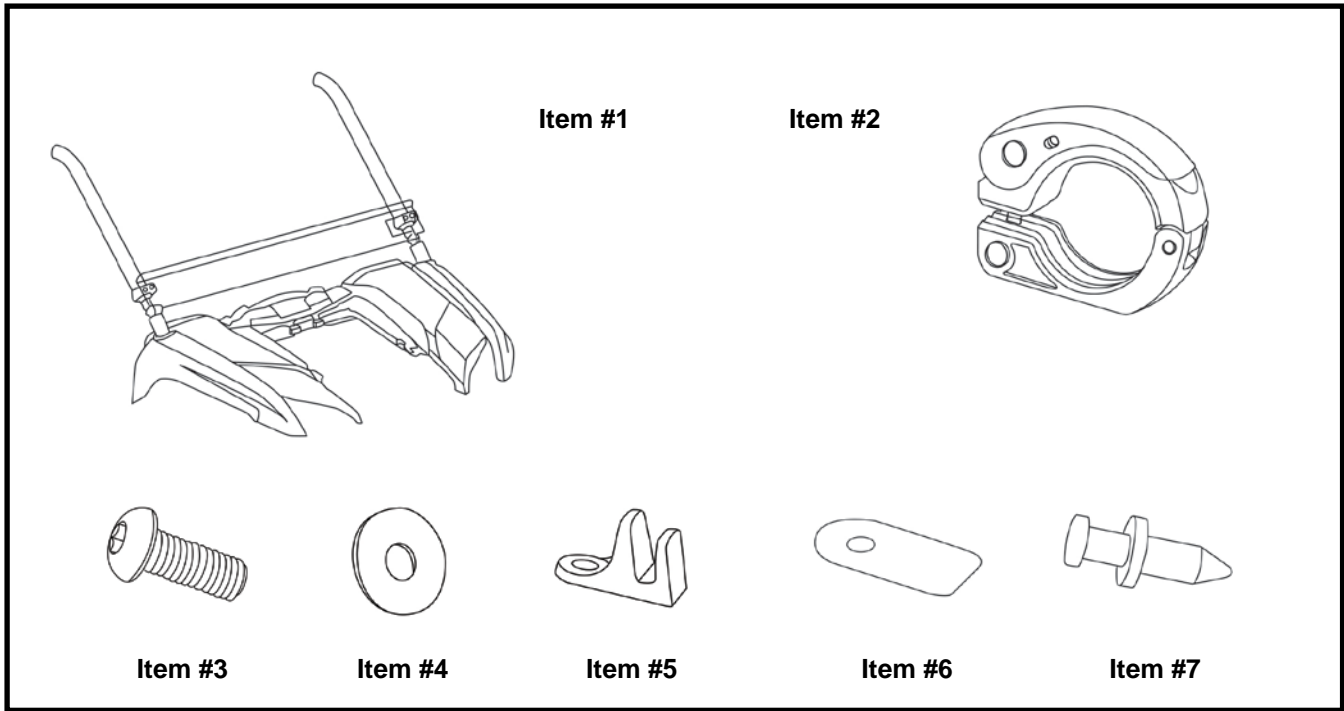

PREPARATION:

1. Place vehicle on a secure and level surface.
2. Set the parking brake.
3. Clean all mounting surfaces before beginning installation.

INSTALLATION:

1. Assemble the clamps (2) onto the wind deflector using the button head bolts (3) and washers (4) as shown in (Fig. 1). Keep the button head bolts loose at this time.
2. Note the clamp orientation. The clamp latches should open inwards as shown in (Fig. 2-4). If the clamp is either too tight or too loose, rotate the latch handle until the clamp is properly secured.
3. Fit the wind deflector onto the vehicle.

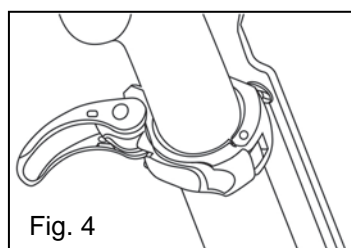
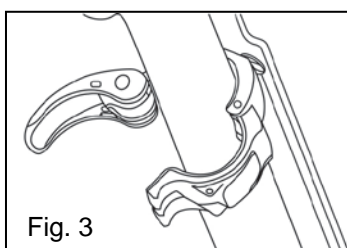
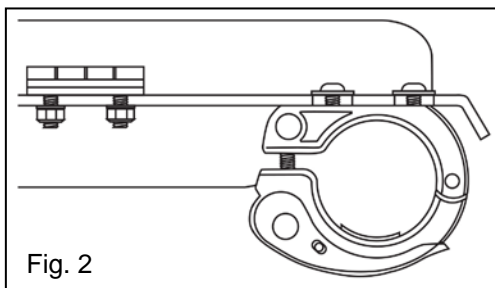

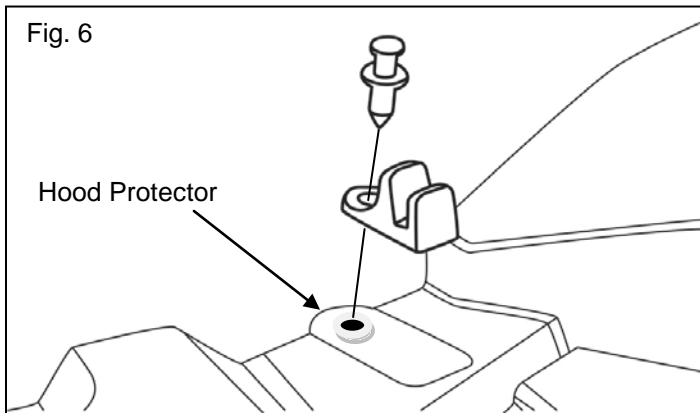
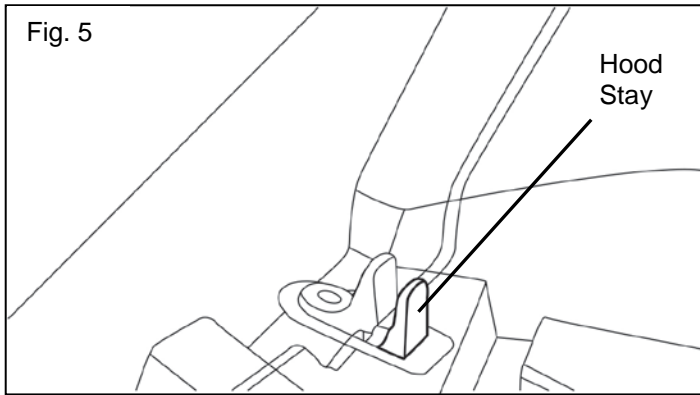

4. Locate the two hood stays (5). Loosen the wind deflector clamps and raise the wind deflector up enough to allow placement of the hood stays as shown in (Fig. 5). Make sure the wind deflector is taut against the hood stay and that there is enough clearance to open the hood.
5. With the hood stays now in place, use a marker to mark the spots to drill a hole in the hood. **Do not drill the hood at this time, as this will be done in a later step.**
6. Remove the wind deflector from the vehicle. Make sure not to lose the hood stays during removal.
7. Using a 5/16" bit, drill out the previously marked holes for the hood stays. **TIP: Maintain shallow drill bit penetration.**
8. Clean the surface of any debris and apply the clear hood protectors (6).
9. Place the hood stay (5) on the hood protector and install the rivet (7) as shown in (Fig. 6).
10. Reinstall the wind deflector by first placing the shield into the hood stays. Then secure all clamps. Adjust as needed.
11. Tighten the button head bolts to 6 ft lbs.

MAINTENANCE:

Periodically check all hardware for tightness and re-torque as required.

CARE AND CLEANING:

Wash using a mild soap and water solution and soft cloth.

CUSTOMER SERVICE:

For further information see your Yamaha dealer.

ESTIMATED TIME TO INSTALL: 0.5 HRS